

Technical Evaluation Report

RoHS EN50581

Report No.: RoHS-110-103

Issued Date: 2021-06-21



Technical Evaluation Report

Cheng Shiu University Electrical Technology Center Environmental & Reliability Testing Laboratory

No. 840, Chengcing Rd., Niaosong Township,

Kaohsiung County 833, Taiwan, R.O.C.

Tel: +886-7-733-7383 Fax: +886-7-733-7390

Email: etc@gcloud.csu.edu.tw

RoHS EN50581

Report No: RoHS-110-103

Applicant: EPILEDS TECHNOLOGIES, INC.
Address: No.7, Kanxi Rd., Tree valley Park,
Xinshi Dist, Tainan City 744092, Taiwan, R.O.C.
Phone: +886-6-5050101 Fax: +886-6-5056533
Product: SMD Lamp
Model No(s): xELS-BLy4zzzwwAE2u series
xELS-CDy4zzzwwAE2u series
xELS-GFy4zzzwwAE2u series
xELS-GUy4zzzwwAE2u series
Variant Description:
x : denote Importer / Customer , each "x" can be 0 to 9 or A to Z
y : denote LED color temperature, each "y" can be 0 to 9 or A to Z
zzz : denote Wattage, each "w" can be 0 to 9 or A to Z
ww : denote size, each "s" can be 0 to 9 or A to Z
u : denote packaging , each "u" can be 0 to 9 or A to Z

Executive Summary

This report is a complete Technical Documentation file to assist the manufacture demonstrating the obligation required by 2011/65/EU directive, and the associated product's compliance with the abovementioned directive.

The report shows that the evaluation product(s) has met the requirement of 2011/65/EU directive. This result is only based on the product sample and/or relevant documents for materials, parts, and/or sub-assemblies submitted by the Applicant and/or the Manufacturer.

This report must not be reproduced, except in full, without the written approval of the issuing testing/evaluating center. The Applicant and Manufacturer have agreed to produce the subject product(s) in accordance with the description of this report. The Manufacturer has also agreed to notify Cheng Shiu University Electrical Technology Center and to request evaluation prior to using alternate parts, components or materials.

Received Date: 2021-06-15

Achieved Date: 2021-06-18

Test Site: No. 840, Chengcing Rd., Niaosong Dist,
Kaohsiung County 83347, Taiwan, R.O.C.
Environmental & Reliability Testing Laboratory,
Electrical Technology Center, Cheng Shiu University



Authorized Representative

Hsing-Feng Chen

H. F. Chen

1 Overview

The submitted sample/ documents are evaluated in following report with regard to the Restriction of the Use of Certain Hazardous Substances in Electrical and Electronic Equipment, 2011/65/EU ("the RoHS Directive") in order to identify the compliance with RoHS apply to the sample.

DIRECTIVE 2011/65/EU OF THE EUROPEAN PARLIAMENT AND OF THE COUNCIL of 8 June 2011 on the restriction of the use of certain hazardous substances in electrical and electronic equipment.

Ensuring of Electrical and Electronic Equipment placed on the market, including cables and spare parts for its repair, its reuse, updating of its functionalities or upgrading of its capacity, does not contain the substances and maximum concentration values tolerated by weight in homogeneous materials:

Lead (0,1 %)
 Mercury (0,1 %)
 Cadmium (0,01 %)
 Hexavalent chromium (0,1 %)
 Polybrominated biphenyls (PBB) (0,1 %)
 Polybrominated diphenyl ethers (PBDE) (0,1 %)
 Bis(2-ethylhexyl) phthalate (DEHP) (0,1 %)
 Butyl benzyl phthalate (BBP) (0,1 %)
 Dibutyl phthalate (DBP) (0,1 %)
 Diisobutyl phthalate (DIBP) (0,1 %)

2 Relevant Standards and Reference

EN 50581:2012 Technical documentation for the assessment of electrical and electronic products with respect to the restriction of hazardous substances

- The standard applied in full or in part here to the evaluation of this entire electrical and electronic product. Especially it provided the key concept and guidance for technical documentation compiling to show the product's compliance with RoHS recast directive (2011/65/EU)

3 General Description of the Product

3.1 Product Information

General item description: SMD Lamp
 xELS-BLy4zzzwwAE2u series
 xELS-CDy4zzzwwAE2u series
 xELS-GFy4zzzwwAE2u series
 xELS-GUy4zzzwwAE2u series

Model no.:

Additional Information:

Variant Description:

x : denote Importer / Customer , each "x" can be 0 to 9 or A to Z
 y : denote LED color temperature, each "y" can be 0 to 9 or A to Z
 zzz : denote Wattage, each "w" can be 0 to 9 or A to Z
 ww : denote size, each "s" can be 0 to 9 or A to Z
 u : denote packaging , each "u" can be 0 to 9 or A to Z

3.2 Product Photo

P/N: xELS-BLy4zzzwwAE2u series ; xELS-CDy4zzzwwAE2u series



P/N: xELS-GFy4zzzwwAE2u series ; xELS-GUy4zzzwwAE2u series



3.3 Exploded Diagram of Product

P/N: xELS-BLy4zzzwwAE2u series

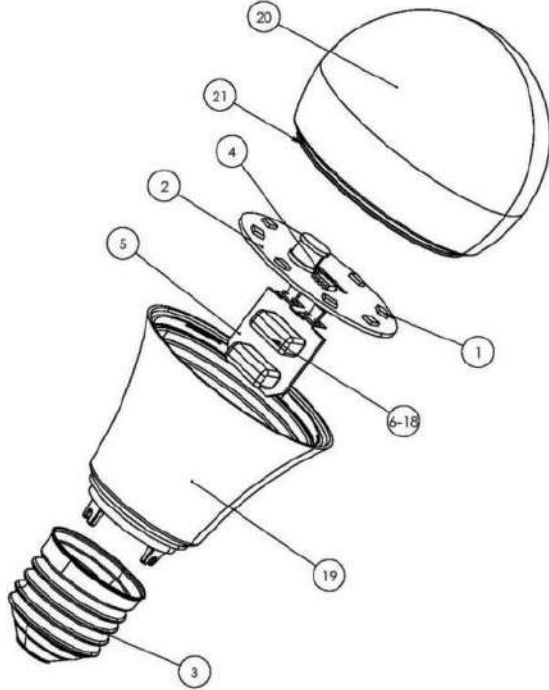

NOTE:
 1. 本特別標示公差之尺寸請依公差等級表
 2. 產品材質需符合RoHS標準
 3. 零件不可以磨牙
 4. 部品在處理和包裝過程中,需防止零件受損壞、氧化和刮傷
 5. 成品顏色白色, 雜質0.0度

No	Item	Description	備註
1-1	LED	LED P2835 9.0V 125LM RA 80	4.7W/8.5W/15W共用
1-2	-Alternative		
1-3	LED	LED P2935 12.0V 125LM RA 80	11W
1-4	-Alternative		
2-1	MCPCB	MCPCB 38.8*1.0mm	4.7W
2-2	MCPCB	MCPCB 46.5*1.2mm	8.5W/11W
2-3	MCPCB	MCPCB 47*1.2mm	15W
3-1	Lamp cap	E27 socket /Nickel platedAL rivet	4.7W/8.5W/11W/15W共用
3-2	-Alternative		
4	Connector	Connector L074K-01-00081-R	4.7W/8.5W/11W/15W共用
5-1	PCB	Driver PCB DY9604 V1.026*23*1.0mm/CEM-3	4.7W/8.5W共用
5-2	Driver PCB	Driver PCB DY9630/2.040*24*1.0mm/22F	11W/15W共用
6-1	SMD resistance	SMD resistance 0805-5.1K-5%	4.7W/8.5W/11W/15W共用
6-2	SMD resistance	SMD resistance 0805-300K-5%	4.7W
6-3	SMD resistance	SMD resistance 0805-4.3R-1%	4.7W
6-4	SMD resistance	SMD resistance 0805-5.1R-1%	8.5W
6-5	SMD resistance	SMD resistance 0805-4.7R-1%	8.5W
6-6	SMD resistance	SMD resistance 1208-300K-5%	8.5W/11W/15W共用
6-7	SMD resistance	SMD resistance 0805-3R-1%	11W
6-8	SMD resistance	SMD resistance 0805-3.3R-1%	11W
6-9	SMD resistance	SMD resistance 0805-2.7R-1%	15W
7	SMD Bridge	Bridge MB10P-1A-100V	4.7W/8.5W/11W/15W共用
8-1	IC	IC KP1054A/VPA/SOP-4 KP1075A/SOP-4 WS9035E SOP-4	4.7W
8-2	IC	IC SR2868B SOP-7 SDH77115H SOP-7 KP1073L SOP-7	8.5W
8-3	IC	IC SR2868D SOP-7 SDH77115H SOP-7 KP1073L SOP-7	11W/15W共用
9-1	SMD inductance	SMD inductance SR54LF 252K/2.5mH/q0.08mm/308.5T	4.7W
9-2	SMD inductance	SMD inductance CD75-25mH q0.11*27.5T/cord 4.8mm	8.5W
9-3	SMD inductance	SMD inductance CD77-2mH/q0.12*243.5T/cord 4.0mm	11W/15W共用
10-1	SMD capacitor	SMD capacitor 1206-100V-1UF-10%-X7R	4.7W
10-2	-Alternative		
11-1	Diode	Diode ES1J/1A/600V/SMA	8.5W/11W共用
11-2	Diode	Diode M7/SMAF/1A/1000V	11W
11-3	Diode	Diode ES2J/2A/600V/SMA	15W
12-1	Electrolytic capacitor	Electrolytic capacitor 3.3uF/400V/6.3*11mm/500H/3mm/105°C	4.7W
12-2	Electrolytic capacitor	Electrolytic capacitor 6.8uF/400V/6.3*12/105°C/3mm	8.5W
12-3	Electrolytic capacitor	Electrolytic capacitor 2.2uF/250V/6.3X9MM/500H/3mm/105°C	8.5W/11W共用
12-4	Electrolytic capacitor	Electrolytic capacitor 4.7uF/250V/6.3*11mm/300H/105°C	11W/15W共用
12-5	Electrolytic capacitor	Electrolytic capacitor 6.8uF/250V/6.3*12mm/300H/105°C	15W
13-1	CBB capacitor	CBB capacitor-104J-400V/9*5.5*9mm/P=7.5mm/3mm	4.7W
13-2	CBB capacitor	CBB capacitor-154J-400V/9*5.5*9mm/P=7.5mm/3mm	11W/15W共用
14	Inductance	E*8 UR magnetic core:3.0mH/3MM	8.5W/11W/15W共用
15	Inductance	Inductance/0510/3.3mH/r type/P=5mm,H=3.5mm	4.7W
16	X capacitor	X capacitor/104J/310V/10*10*5mm/P=7.5MM/3mm	8.5W/11W/15W共用
17-1	DIP FUSE	FUSE RXF-1WS-4TQ-5%/PIN=0.5mm/L48mm	4.7W
17-2	-Alternative		
17-3	DIP FUSE	FUSE RXF-1WS-10Q-5%/PIN=0.5mm/L65mm	8.5W/11W/15W共用
17-4	-Alternative		
18-1	Wires	Wires 26A/WG/25MM/3-15/White	4.7W
18-2	Wires	Wires 26A/WG/45MM/3-15/White	8.5W
18-3	Wires	Wires 26A/WG/50MM/3-15/White	11W/15W共用
19-1	Lamp shell	A60 Aluminum coated plastic / 50*141MM	4.7W
19-2	Lamp shell	A60 Aluminum coated plastic / 54*147MM	8.5W
19-3	Lamp shell	A60 Aluminum coated plastic / 54*157MM	11W
19-4	Lamp shell	A60 Aluminum coated plastic / 54*170MM	15W
20	Lamp cover	A60 Cover/6045/PC/ / 60*H50mm/ / 45mm/transmittance 90%	4.7W
20	Lamp cover	A60 Cover/6045/PC/ / 60*H44.4mm/ / 40mm/transmittance 90%	8.5W/11W/15W共用
21	Silicone glue	Silicone 6239	4.7W/8.5W/11W/15W共用

REV	DATE	BY	CHECKED	DATE	BY	CHECKED	DATE	BY	CHECKED
1	2011/03/01	WJ	WJ	2011/03/01	WJ	WJ	2011/03/01	WJ	WJ
2	2011/03/01	WJ	WJ	2011/03/01	WJ	WJ	2011/03/01	WJ	WJ
3	2011/03/01	WJ	WJ	2011/03/01	WJ	WJ	2011/03/01	WJ	WJ

P/N: xELS-CDy4zzzwwAE2u series

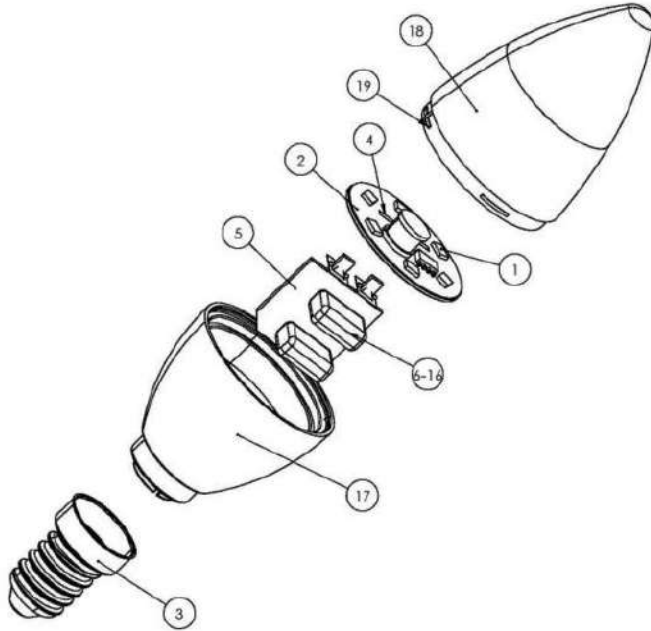

NOTE:
 1. 未特別標示公差之尺寸請依公差等級表
 2. 產品材質需符合RoHS標準
 3. 零件不可以磨牙
 4. 製品在處理製程中,需防止零件受損壞、氧化和刮傷
 5. 成品顏色白色,亮度60度

No	Item	Description	備註
1-1	LED	LED P2835 9.0V 125LM RA 80	2.5W/4.7W/7W共用
1-2	-Alternative		
2-1	MCPCB	MCPCB 32*1.6mm	2.5W/4.7W共用
2-2	MCPCB	MCPCB 33*1.2MM	7W
3-1	Lamp cap	E27 / E14 socket /Nickel plated/AL rivet	2.5W/4.7W/7W共用
3-2	-Alternative		
4	Connector	Connector L074K-01-000B1-R	2.5W/4.7W/7W共用
5-1	PCB	Driver PCB DY0632 V1.0/15*17*1.0mm/22F	2.5W/4.7W共用
5-2		Driver PCB DY0636V1.0/31*22*1.0mm/22F	7W
6-1	SMD Resistance	SMD resistance 0805-5.1K-5%	2W/4.7W共用
6-2		SMD resistance 0805-300K-5%	2W/4.7W共用
6-3		SMD resistance 0805-5.1R-1%	2W
6-4		SMD resistance 0805-4.32-1%	4.7W/7W共用
6-5		SMD resistance 0805-4.7K-5%	7W
6-6		SMD resistance 1206-300K-5%	7W
7	SMD Bridge	Bridge M010F-1A-1000V	2.5W/4.7W/7W共用
8-1	IC	IC KP1051AVPA/SOP-4 KP1075A/SOP-4 WS9035E SOP-4	2W/4.7W共用
8-2		IC KP1054BVPA/SOP-4 KP1075B/SOP-4 WS9035E SOP-4	7W
9	SMD inductance	SMD inductance 3R54L/-252K/2.5mm*9.0mm*308.5T	2.5W/4.7W共用
10-1	SMD capacitor	SMD capacitor1206-250V-100NF-10%-X7R	2.5W/4.7W共用
10-2	-Alternative		
11-1	Electrolytic capacitor	Electrolytic capacitor2.2UF/400V/6.3*11mm*5000H/3mm/105°C	2.5W
11-2		Electrolytic capacitor 3.3UF/400V/6.3*11mm*5000H/3mm/105°C	4.7W/7W共用
11-3		Electrolytic capacitor 3.3UF/250V/6.3*9mm//105/3mm	7W
12	Inductance	inductance/0510/3.3MH type/P=5mm/H=3.5mm	2.5W/4.7W/7W共用
13	Transformer	EE8.0/5.6mH/45*6*9.0.11mm/270T/155°C	7W
14	CBB capacitor	CBB capacitor104J-400V/9*5.5*5mm/P=7.5mm/3mm	2.5W/4.7W共用
15-1	DIP FUSE	FUSE ROX-1WS-27Q-5%/PIN-0.5mm/L 65mm	2.5W/4.7W共用
15-2	-Alternative		
15-3	DIP FUSE	FUSE ROX-1WS-10Q-5%/PIN-0.5mm/L 60mm	7W
15-4	-Alternative		
16-1	Wires	Wires 28AWG/30MM/3-15/White	2.5W/4.7W共用
16-2		Wires 28AWG/45MM/3-15/White	7W
17-1	Lamp shell	C37Y-E2/E27/E14/ Housing/PBT/L punching/ø36.3*H35mm	2.5W/4.7W共用
17-2	Lamp cover	C37Y-E2/E27/E14/ Housing/PBT/L punching/ø37*H48mm	7W
18	Lamp cover	C37Y-FC Cover /Injection molding / transmittance - 90%	2.5W/4.7W/7W共用
19	Silicone glue	Silicone 6239	2.5W/4.7W/7W共用

REV	DATE	DESCRIPTION	BY	CHK	APP	DATE	REVISION	REASON
01	2023/03/01	Initial Release	ED	ED	ED	2023/03/01	1	Initial Release

EDI 光統科技股份有限公司
 EPILEDS TECHNOLOGIES, INC.

REV: E21 q03_EU Candle Series exploded drawing
 DATE: 2023/03/01

P/N: xELS-GFy4zzzwwAE2u series

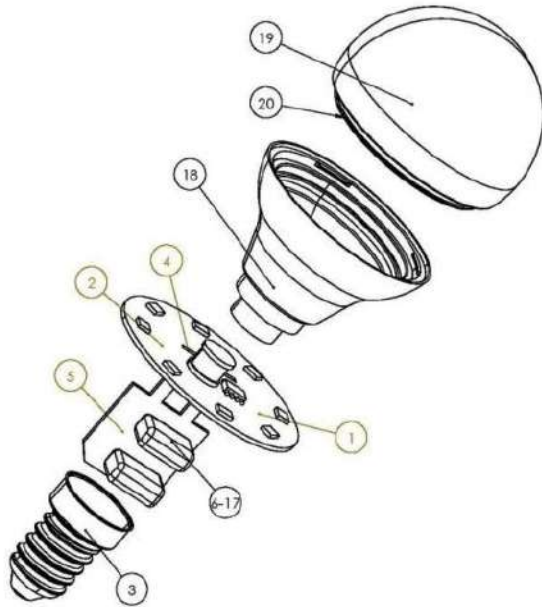

NOTE:
 1. 本特別標示公差之尺寸請依公差等級表
 2. 產品材料皆符合RoHS標準
 3. 零件不可以磨牙
 4. 製品在處理包裝過程中,需防止零件受損壞、氧化和刮傷
 5. 成品顏色白色,硬度90度

No	Item	Description	備註
1-1	LED	LED P2835 9.0V 125LM RA 80	2.5W/4.7W/7W共用
1-2	-Alternative		
2-1	MCPCB	MCPCB 32*1.0mm	2.5W/4.7W共用
2-2		MCPCB 36*1.2mm	7W
3-1	Lamp cap	E27 / E14 holder /Nickel plated/AL rivet	2.5W/4.7W/7W共用
3-2	-Alternative		
4	Connector	Connector L074K-01-000B1-R	2.5W/4.7W/7W共用
5-1	PCB	Driver PCB DY0632 V1.0/15*17*1.0mm/22F	2.5W/4.7W共用
5-2		Driver PCB DY0636V1.0/31*22*1.0mm/22F	7W
6-1	SMD Resistance	SMD resistance 0805-5.1K-5%	2.5W/4.7W共用
6-2		SMD resistance 0805-300K-5%	2.5W/4.7W共用
6-3		SMD resistance 0805-5.1R-1%	2.5W
6-4		SMD resistance 0805-4.3R-1%	4.7W
6-5		SMD resistance 0805-9.1R-1%	7W
6-6		SMD resistance 0805-4.7K-5%	7W
6-7		SMD resistance 1206-300K-5%	7W
7	SMD Bridge	Bridge MB10F-1A-1000V	2.5W/4.7W/7W共用
8	IC	IC KP1054AVPA/SOP-4 KP1075A/SOP-4 WS9035E SOP-4	2.5W/4.7W/7W共用
9	SMD inductance	SMD inductance SR54L-F-252K2.5mHq0.06mm/308 5T	2.5W/4.7W共用
10-1	SMD capacitor	SMD capacitor 1206-250V-100NF-10%-X7R	2.5W/4.7W共用
10-2	-Alternative		
11-1	Electrolytic capacitor	Electrolytic capacitor 3.3UF/400V/6.3*11mm/5000H/3mm/105°C	2.5W/4.7W/7W共用
11-2		Electrolytic capacitor 3.3UF/250V/6.3*9mm/155°C/3mm	7W
12	Inductance	Inductance 0510/3.3Mh in type/P=8mm/H=3.5mm	2.5W/4.7W/7W共用
13	Transformer	EE9.8/5.0mH±5%/0.11mm/273T/155°C	7W
14	CBB capacitor	CBB capacitor-104J-400V/9*5.6*9mm/P=7.5mm/3mm	2.5W/4.7W共用
15-1	DIP FUSE	RXF-1WS-2/D-5%/PIN=0.5mm/L 55mm	2.5W/4.7W共用
15-2	-Alternative		
16-1	DIP FUSE	FUSE RXF-1WS-10Q-5%/PIN=0.5MM/L 60MM	7W
16-2	-Alternative		
17-1	Wires	Wires 26AWG /30MM/3-15/White	2.5W/4.7W共用
17-2		Wires 26AWG 45MM/3-15/White	7W
18-1	Lamp shell	G45Y-E27/E14/ Housing/PBT/AL punchingq-43*H43mm	2.5W/4.7W共用
18-2		G45Y-E27/E14/ Housing/PBT/AL punchingq-43*H43mm	7W
19	Lamp cover	G45Y-PC Cover /injection molding /transmittance>90% 45*32	2.5W/4.7W/7W共用
20	Silicone glue	Silicone 6239	2.5W/4.7W/7W共用

REV	DATE	DESCRIPTION
1	2014/08/20	Initial Release
2	2014/08/20	Initial Release
3	2014/08/20	Initial Release
4	2014/08/20	Initial Release
5	2014/08/20	Initial Release

NO	DATE	BY	CHK	APP	REVISION	DESCRIPTION
1	2014/08/20	WJ	WJ	WJ	1.0	Initial Release
2	2014/08/20	WJ	WJ	WJ	1.0	Initial Release
3	2014/08/20	WJ	WJ	WJ	1.0	Initial Release
4	2014/08/20	WJ	WJ	WJ	1.0	Initial Release
5	2014/08/20	WJ	WJ	WJ	1.0	Initial Release

CH	NAME	NO/ISSUE	QTY	REMARKS

EDI 光鋅科技股份有限公司
EPILED TECHNOLOGIES, INC.

FILE: E21a03_EU Golf series exploded drawing

DATE: 2014/08/20

P/N: xELS-GUy4zzzwwAE2u series

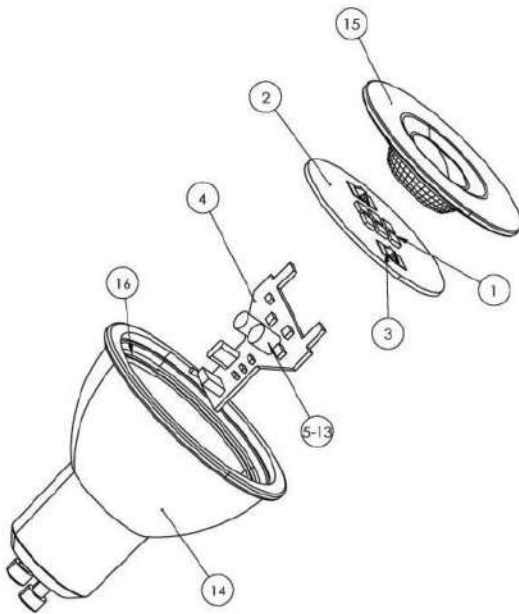

No	Item	Description	備註
1-1	LED	LED P2835 9.0V 125LM RA 80	4W5.5W共用
1-2	-Alternative		
1-3	LED	LED P2835 12.0V 125LM RA 80	7W
1-4	-Alternative		
2	PCB	MCPCB 38.5*1.0MM	4W5.5W/7W共用
3	Connector	Connector L074K-01-000B1-R	4W5.5W/7W共用
4	PCB	Driver PCB DY0565 V3.0/30*35*1.0mm/22F	4W5.5W/7W共用
5-1		SMD resistance 0805-5 1R-1%	4W5.5W/7W共用
5-2	SMD Resistance	SMD resistance 0805-200K-5%	4W5.5W/7W共用
5-3		SMD resistance 0805-4 7K-5%	4W5.5W/7W共用
6	SMD Bridge	Bridge MB10F-1A-1000V	4W5.5W/7W共用
7	IC	IC KP1054VPA/SOP-4 KP1075A/SOP-4 WS9035E SOP-4	4W5.5W/7W共用
8-1		Electrolytic capacitor 3.3UF/400V/6.3*9mm/D=7mm/105°C	4W
8-2	Electrolytic capacitor	Electrolytic capacitor 1UF/400V/5*9mm/105°C/8mm	4W5.5W/7W共用
8-3		Electrolytic capacitor 4.7UF/400V/6.3*9mm/D=7mm/105°C	5.5W/7W共用
9-1	Transformer	EE9 8/3mm/45%/250T/g0.12mm*1/2LEW/155°C/PC40 core	4W5.5W共用
9-2		EE9 8/5mm/45%/250T/g0.12mm*1/2LEW/155°C/PC40 core	7W
10	CBB capacitor	CBB capacitor-154J-400V/9*5.5*9mm/P=7.5mm/3mm	4W5.5W/7W共用
11	Inductance	Inductance/0510/3.3MH/n type/P=12mm/H=4mm	4W5.5W/7W共用
12-1	DIP FUSE	FUSE RXF-1WS-100-5%/PIN=0.5mm/L85mm	4W5.5W/7W共用
12-2	-Alternative		
13	Wires	Wires 24AWG/30MM/3-20/White	4W5.5W/7W共用
14	Lamp shell	GU10-M Aluminum coated plastic /D50*H47.5mm	4W5.5W/7W共用
15	Lamp cover	GU10 Lens /PC /38*/D44mm*H9.0mm	4W5.5W/7W共用
16	Silicone glue	Silicone 6516	4W5.5W/7W共用

NOTE:
 1. 未特別標示公差之尺寸請依公差等級表
 2. 產品材料皆符合RoHS 標準
 3. 零件不可以磨牙
 4. 組裝時應避開組裝過程中,需防止零件受振盪、氧化和刮傷
 5. 成品顏色白色,硬度60度

REV	DATE	DESCRIPTION	BY	CHK	APP	DATE	REVISION	REMARKS
1	2011-08-11	Initial Release	ED	ED	ED	2011-08-11	1	
2	2011-08-11	Initial Release	ED	ED	ED	2011-08-11	2	
3	2011-08-11	Initial Release	ED	ED	ED	2011-08-11	3	
4	2011-08-11	Initial Release	ED	ED	ED	2011-08-11	4	
5	2011-08-11	Initial Release	ED	ED	ED	2011-08-11	5	

光銳科技股份有限公司
 EPILED TECHNOLOGIES, INC.

TITLE: E21a03_EU GU10 Series exploded drawing
 DRAWN: ED
 CHECKED: ED
 APPROVED: ED

3.4 Submitted Documents

This product is evaluated according to below documents provided by applicant:

- Bill of Material (BOM)
- Test reports
- Declaration by client and supplier
- Others

3.5 Bill of Material (BOM)

P/N:

xELS-BLy4zzzwwAE2u series

xELS-CDy4zzzwwAE2u series

xELS-GFy4zzzwwAE2u series

xELS-GUy4zzzwwAE2u series

版次: V1.0

P/N	日期	P/N	日期	P/N	日期
DELS-BL344P7B0AE21	20210608	DELS-CDC400714AE21	20210609	DELS-GF344P727AE21	20210610
DELS-BL444P7B0AE21	20210608	DELS-CD342P527AE21	20210609	DELS-GF444P727AE21	20210610
DELS-BLC44P7B0AE21	20210608	DELS-CD442P527AE21	20210609	DELS-GFC44P727AE21	20210610
DELS-BL348P5B0AE21	20210608	DELS-CDC42P527AE21	20210609	DELS-GF3400727AE21	20210610
DELS-BL348P5B0AE23	20210608	DELS-CD344P727AE21	20210609	DELS-GF4400727AE21	20210610
DELS-BL448P5B0AE21	20210608	DELS-CD444P727AE21	20210609	DELS-GFC400727AE21	20210610
DELS-BLC48P5B0AE21	20210608	DELS-CDC44P727AE21	20210609	DELS-GU34004T8AE21	20210610
DELS-BL34011B0AE21	20210608	DELS-CD3400727AE21	20210609	DELS-GU44004T8AE21	20210610
DELS-BL44011B0AE21	20210608	DELS-CD4400727AE21	20210609	DELS-GUC4004T8AE21	20210610
DELS-BLC4011B0AE21	20210608	DELS-CDC400727AE21	20210609	DELS-GU345P5T8AE21	20210610
DELS-BL34015B0AE21	20210608	DELS-GF342P514AE21	20210609	DELS-GU445P5T8AE21	20210610
DELS-BL44015B0AE21	20210608	DELS-GF442P514AE21	20210609	DELS-GUC45P5T8AE21	20210610
DELS-BLC4015B0AE21	20210608	DELS-GFC42P514AE21	20210609	DELS-GU34007T8AE21	20210610
DELS-CD342P514AE21	20210608	DELS-GF344P714AE21	20210609	DELS-GU44007T8AE21	20210610
DELS-CD442P514AE21	20210608	DELS-GF444P714AE21	20210609	DELS-GUC4007T8AE21	20210610
DELS-CDC42P514AE21	20210608	DELS-GFC44P714AE21	20210609	DELS-BL448P5B0AE23	20210617
DELS-CD344P714AE21	20210608	DELS-GF3400714AE21	20210609	DELS-BL548P5B0AE23	20210617
DELS-CD344P714AE23	20210608	DELS-GF4400714AE21	20210609	DELS-CD444P714AE23	20210617
DELS-CD444P714AE21	20210608	DELS-GFC400714AE21	20210609	DELS-GF344P727AE23	20210617
DELS-CDC44P714AE21	20210608	DELS-GF342P527AE21	20210609	DELS-GF444P727AE23	20210617
DELS-CD3400714AE21	20210608	DELS-GF442P527AE21	20210609		
DELS-CD4400714AE21	20210608	DELS-GFC42P527AE21	20210609		

4 Product Evaluation Description

4.1 Product Classification

The submitted product is evaluated with regard to RoHS Directive 2011/65/EU in the scope of the respective directive:

- 1. Large household appliances
- 2. Small household appliances
- 3. IT and telecommunications equipment
- 4. Consumer equipment
- 5. Lighting equipment
- 6. Electrical and electronic tools
- 7. Toys, leisure and sports equipment
- 8. Medical devices
- 9. Monitoring and control instruments including industrial monitoring and control instruments
- 10. Automatic dispensers
- 11. Other EEE not covered by any of the categories above

4.2 Evaluation Procedure

1. Component / Material selection

- BOM
- Exploded diagram

2. Evaluation base

Evaluation is according to following documents/results/experience to process.

- 1 Test report provided by vendor
- 2 Compliance declaration or supplementary document

Once test result excess following limit in homogeneous material basis or 40% of following limit in composite material basis, the exemptions of 2011/65/EU should be checked and the compliance declaration from vendor is required.

Lead (0,1 %)
 Mercury (0,1 %)
 Cadmium (0,01 %)
 Hexavalent chromium (0,1 %)
 Polybrominated biphenyls (PBB) (0,1 %)
 Polybrominated diphenyl ethers (PBDE) (0,1 %)
 Bis(2-ethylhexyl) phthalate (DEHP) (0,1 %)
 Butyl benzyl phthalate (BBP) (0,1 %)
 Dibutyl phthalate (DBP) (0,1 %)
 Diisobutyl phthalate (DIBP) (0,1 %)

<Null below>

